



Survey of "Addition to Peter's Lott" for Peter Gordy II

Peter Gordy I received a common warrant for "Addition to Peter's Lott" containing 50 acres in Worcester County Maryland on 14 December 1755. On 21 March 1759 a survey of the land was recorded and he assigned the warrant to his son, Peter Gordy II. The document includes the survey description and plat. We do not have the citation information.

Facsimile of this document

Transcription of this document is not yet available.

Return to the [Original Documents Index](http://www.gordyfamily.org/genealogy/origdocs-index.html) at GordyFamily web site.
<http://www.gordyfamily.org/genealogy/origdocs-index.html>

Plantation when on the now line thence running N. 55. W. 200 p. thence S. 8. E. 70 p.
 N. 73. E. 123 p. thence S. 35. E. 40 p. thence S. 82. W. 24 p. thence S. E. 17 p. thence
 S. 50. W. 24 p. thence S. 30. E. 106 p. thence S. 37. W. 42 p. thence S. 43. E. 126 p. thence
 S. 64. W. 32 p. thence as a right line to the first boundary containing and
 now laid out for 144. ac. of Land more or less **Discovered** Discovery and
 Venture to be holden of the Mannour of Worcester

This Plot laid down of 100 p. in the
 by a scale of 100 p. in the inch
 N. 55. W. 200
 S. 35. E. 40
 S. 82. W. 24
 S. E. 17
 S. 50. W. 24
 S. 30. E. 106
 S. 37. W. 42
 S. 43. E. 126
 S. 64. W. 32
 as a right line

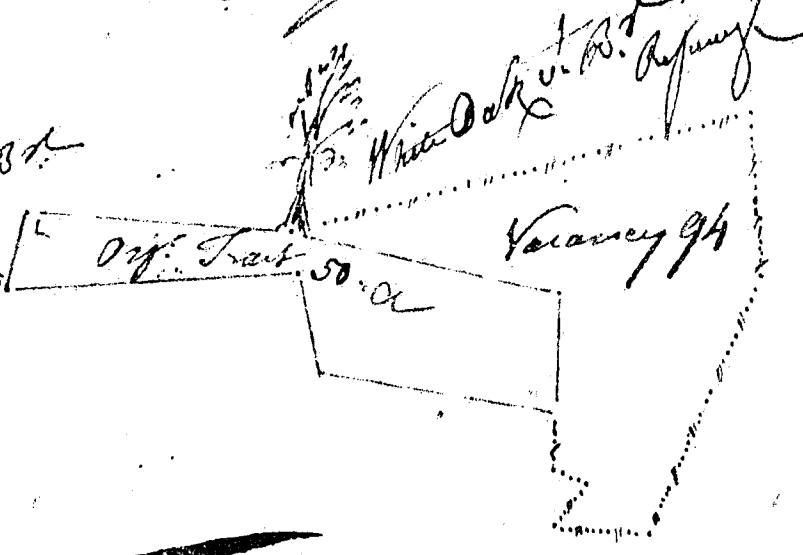

Maryland 1755

April 3-1755

By virtue of a Comon Warrant granted unto Peter Gandy Junr of Warr
 for 50 ac. of Land bearing date of 14. day of Decr. Anno: Dom: 1755
 which s. Warrant is as ye. over unto Peter Gandy Junr of the Co. of
 these are returned by to wit: that J. John Perry Senr. Senr. Warr. Under the
 name of Benj. T. Baker Junr. have awarded by Senr. & laid out for the ac.
 Peter Gandy Junr. that part or parcel of Land addition to Peter Gandy Junr.
 lying & being in the Co. of Bound. as follows **Discovered** Discovery and
 Venture to be holden of the Mannour of Worcester
 on the south side of Daniel Melhams Plantation & on the N. E. side of
 Run Ridge thence running N. 50. E. 80 p. thence N. . . 80 p. thence
 N. 75. W. 90 p. thence as a right line to the first boundary containing
 & now laid out for 50 ac. of Land more or less to be holden of the
 Mannour of Worcester

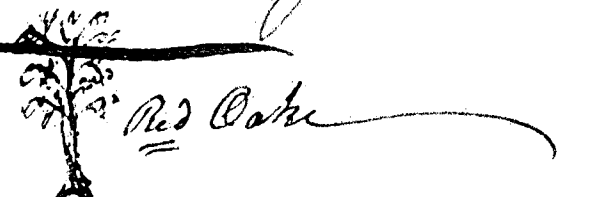

This Plot laid down
 of 50 p. in the inch

addition to Peter Gandy
 50 ac

Witness Peter Gandy Junr. by Peter Gandy
 Warr. 22 April 1755
 Test J. Langr. Rownd